

MahaRERA No. P51700056278
<https://maharera.maharashtra.gov.in/>



 **DOSTI
WILLOW**
THANE

MR. DEEPAK GORADIA
CHAIRMAN & MANAGING DIRECTOR, DOSTI REALTY



Introducing Dosti Willow in the heart of Dosti West County. It isn't just a tower, it's a dream brought to life. Thoughtfully positioned at the very centre of the township, it offers panoramic views of one of Thane's largest landscaped podium gardens. A personal passion project, its unique **Y shape** was born from countless hours of redesigning to ensure **larger, waste-free homes** with **brehtaking views** and abundant light. Dosti Willow is where design meets emotion, and where you'll truly feel you belong.

BUILT BY UNDERSTANDING.

Built to be your friends for life.

A city where nature and progress coexist in perfect harmony, Thane has rapidly evolved into a premier residential destination and a vibrant commercial hub. With robust infrastructure, seamless connectivity, and a flourishing social fabric, it continues to attract discerning homebuyers and businesses alike.

At the heart of this transformation stands **Mr. Deepak Goradia**, the visionary leader behind **Dosti West County**, who has been instrumental in redefining Thane's real estate landscape. Nearly 25 years ago, at a time when Mumbai's land availability was limited, he identified Thane as the next frontier of urban growth. This foresight led to the launch of **Maitri Gardens** in 2001, marking Dosti Realty's pioneering entry into Thane.

Since then, the journey has spanned over **9 million sq. ft.** of thoughtfully crafted developments across Thane. From **Dosti Vihar** at Pokhran Road, which one of the first projects in Thane to introduce cutting-edge Aluminium Formwork technology and a large clubhouse, to iconic projects like **Dosti Imperia** at Manpada and **Dosti Pinnacle** in Wagle Estate, Mr. Goradia has consistently pushed the boundaries of urban living.

Mr. Deepak Goradia's ability to identify high-potential locations well before they become mainstream, paired with a deep understanding of evolving customer needs, has enabled him to create communities that blend world-class infrastructure with the serenity of nature.

Dosti West County, Balkum's transformative **105-acre township** is the latest chapter in this legacy. Strategically located near the upcoming Balkum Metro station and equidistant from both ends of Thane, Balkum is emerging as the city's new urban epicentre. Envisioned as a holistic, multigenerational neighbourhood, Dosti West County integrates residential, commercial, educational, and retail, delivering a balanced lifestyle for today and tomorrow.

At the heart of this township is **Dosti Willow**, the newest expression of Mr. Goradia's vision. Featuring premium 2 and 3-bed residences, Dosti Willow offers a lifestyle of modernity, convenience, and tranquillity. It is a testament to Dosti Realty's commitment to thoughtful design, superior amenities, and trusted legacy.

As Thane continues to rise as a city of the future, Mr. Deepak Goradia remains steadfast in his mission to shape communities, elevate lifestyles, and set new benchmarks in real estate excellence.



1

INTRODUCTION

2

LOCATION

3

EXPERIENCES

4

DOSTI CLUB
COUNTY

5

DOSTI
WESTWOOD

6

BLOOMING
CHILDHOODS

7

RESIDENCES

8

PARTNERS

9

FLOOR
PLANS

10

OUR
LEGACY

UNVEILING

LIFE'S FINEST COMFORTS, LUXURIES,
and the finest moments.

LIFE'S FINEST SERENITY, DELIGHTS,
and the finest experiences.

LIFE'S FINEST INSPIRATION, ESCAPES,
and the finest views.

LIFE'S FINEST CONNECTIONS, PLEASURES,
and the finest community living.

LIFE'S FINEST DISCOVERIES, HORIZONS,
and the finest residences.



Representative image



LAUNCHING

LIFE'S FINEST

for Thane's finest.

It's only once in a lifetime when you find a home that brings everything you've ever dreamed of to life. One of the finest addresses in Dosti Realty's legacy, Dosti Willow is the benchmark of fine living.

Set against picturesque landscapes in the heart of Thane, adorned by expansive layouts, and filled with thoughtful avenues of rest and pleasure, come home to ultra spacious two and three bed residences filled with life's finest joys.





Artist's Impression

COME HOME TO DOSTI WEST COUNTY.

The future of living.

Dosti West County is the pinnacle of modern living, where luxury harmoniously blends with the serenity of nature. More than just a collection of homes, it is a thoughtfully planned community that inspires a lifestyle beyond limits for over 1,400 residents today, and over 3,050 residents more in the upcoming towers.

With the Dosti Club County amenities and experiences fully ready, residents are already enjoying an enriching environment for every age group. The community is surrounded by retail spaces, ensuring everyday ease is always within reach.

A reflection of Dosti Realty's commitment to integrating nature with contemporary urban living, Dosti West County is a vibrant and sustainable community that welcomes home the evolving preferences of today's homebuyers.



Representative Image

WHY DOSTI WEST COUNTY

is one of Thane's finest addresses.



1 minute from the upcoming
Balkum Metro Station



EuroSchool less than
1 minute away



In the heart of social infrastructure
and city's key landmarks



A safe and superior gated
community with power backup



Home to over 3,500 lush trees
and a healthy Air Quality Index



High street retail
and shopping experience



Like-minded community and
a peaceful neighbourhood



Open-to-sky podium spans across
6.5 acres (26,305 sq. mtr.) in Sector 1



Clubhouse spans across
44,795 sq. ft. (4,162 sq. mtr.)



Thane is a thriving destination where opportunity meets lifestyle. With 4 lakh new jobs projected in the next five years and global giants like TCS and Amazon setting up base, Thane is becoming a growth powerhouse. Complementing its commercial boom is a residential paradise with quality homes, seamless connectivity, flourishing infrastructure, and green spaces. Come home to thrive amidst a landscape of progress, to call home today and build a legacy for tomorrow.

Eastern Express Highway, **3 Mins**
Mulund, **15 Mins**
Airoli, **25 Mins**
Powai, **30 Mins**
Ghansoli, **30 Mins**

Mahape, 32 Mins
BKC, 35 Mins
Vashi, 35 Mins
Andheri, 40 Mins
SEEPZ, 40 Mins

Kalyan, **40 Mins**
 Borivali, **45 Mins**
 T2 International Airport, **50 Mins**
 Goregaon, **50 Mins**
 Nerul, **55 Mins**

Fort, 60 Mins
Parel, 60 Mins
Panvel, 65 Mins

*All proposed infrastructures mentioned are as per what is shown on MMRDA website as on 20th Dec 2024. Colaba

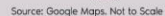



Representative Image

A PROMISE OF PROGRESS TODAY.

A thriving reality tomorrow.

Imagine a life where the city's traffic and chaos no longer dictate your day. Thane's upcoming world-class infrastructure will transform how you commute, making every corner of the city effortlessly accessible and cutting travel time in half. Step into a future where every drive is smooth, every moment is yours to savour, and the luxury of always being on time becomes your new normal.



METRO LINE 5 WITH BALKUM STATION

To ease traffic congestion and reduce travel time between Thane, Bhiwandi and Kalyan



METRO LINE 4

To connect Wadala, Ghatkopar, Mulund, Thane, and Kasarvadavali



PROPOSED METRO LINE 10

Expected to provide and ease connectivity between Mira-Bhayandar and Thane



THANE-BORIVALI TUNNEL

A 10-km tunnel to connect Thane with Borivali passing through Sanjay Gandhi National Park

Source: Free Press Journal article dated November 11, 2022



THANE-DOMBIVLI BRIDGE

The 980 metres long bridge over the Ulhas Creek will connect Thane and Dombivli

Source: Times of India article dated August 11, 2020



PROPOSED CST-THANE UNDERGROUND RAILWAY LINE

A 34-km, high-speed underground rail route between Chhatrapati Shivaji Maharaj Terminus and Thane

Source: The Indian Express article dated July 26, 2019



RO-RO WATERWAYS

A hovercraft will connect South Mumbai and Navi Mumbai in Phase 1, and Thane in Phase 2

Source: Times of India article dated August 11, 2020



PROPOSED VIRAR ALIBAUG MULTI-MODAL TRANSPORT CORRIDOR

Will be constructed in two phases to reduce travel time between Virar, Navi Mumbai International Airport and Alibaug by 50%

Source: Indian Express article dated June 22, 2021



THANE WATERWAYS

Inland water transport will connect Thane, Kalyan, and Vasai and ease the commute

Source: Times of India article dated March 12, 2022



PROPOSED COASTAL ROAD, BALKUM TO GAIMUKH

To reduce the travel time to a few minutes and ease congestion on the main highway

Source: Hindustan Times article dated July 16, 2022



PROPOSED EASTERN FREEWAY EXTENSION, CHEMBUR TO THANE

By connecting two significant points in the city, the extension will help reduce highway traffic bottlenecks

Source: Times of India article dated November 16, 2022



LIFE'S FINEST WAY

to get around the city.

At Dosti Willow, everything you'll ever need, from essentials to indulgences, is just minutes away. Come home to a life of easy connectivity, convenience, and never running late.

HIGHLIGHTS JUST A MINUTE AWAY

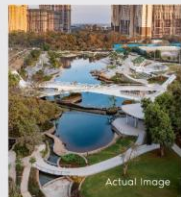

NAMO Grand Central Park



Iskon Temple

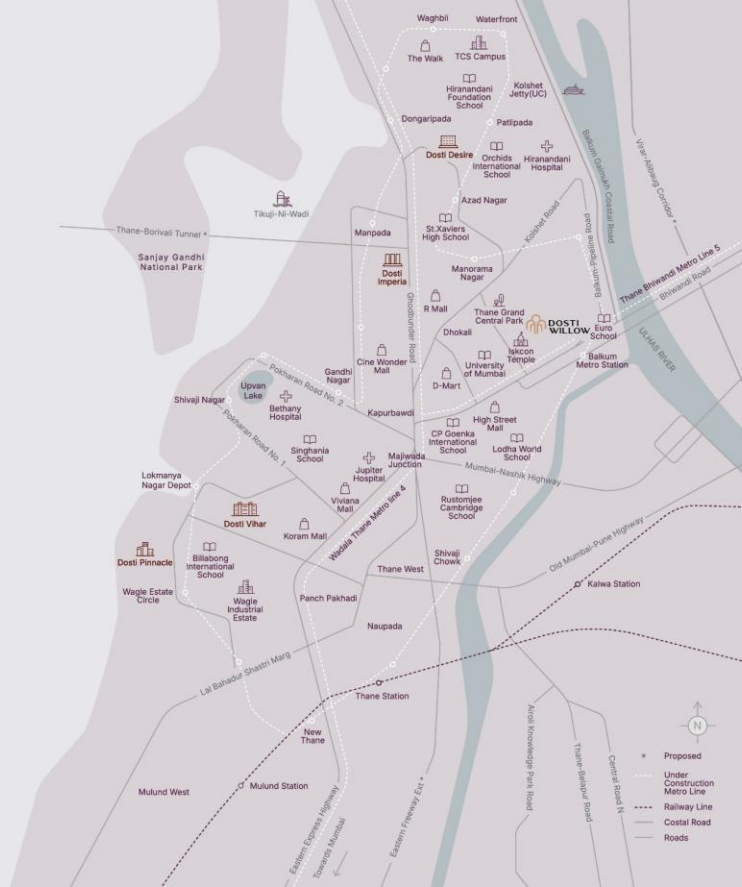

A BRIGHTER FUTURE FOR YOUR CHILDREN

EuroSchool, **1 Min**
CP Goenka International School, **3 Mins**
University of Mumbai, Thane sub-campus, **5 mins**
St. Xavier's English High School & Jr. College, **10 Mins**

Rustomjee Cambridge School, **10 Mins**
Lodha World School, **12 Mins**
TMC Law College, **14 Mins**
Orchids International School, **15 Mins**

Rainbow International School, **15 Mins**
Smt. S. Singhania High School, **15 Mins**
Hiranandani Foundation School, **18 Mins**
Billabong High International School, **20 Mins**

ENTERTAINING IN EVERY WAY

Lake City Mall, **2 Mins**
Kala Bhavan, **2 Mins**
Cinema Star, **2 Mins**
High Street Mall, **3 Mins**
Cinemax, **7 Mins**

D Mart, **8 Mins**
Cinepolis, **10 Mins**
Star Bazaar, **10 Mins**
R Mall, **10 Mins**
Viviana Mall, **10 Mins**
Tikuji-ni-Wadi, **12 Mins**

Suraj Water Park, **15 Mins**
Hypercity, **15 Mins**
Korum Mall, **15 Mins**
The Walk, **15 Mins**
Dr. Kashinath Ghanekar Auditorium, **15 Mins**

FINE DINNER DATES, FINER MEMORIES

Mainland China, **8 Mins**
Barbeque Nation, **10 Mins**

China Bistro, **10 Mins**
Oriental Spice, **10 Mins**

The Yellow Chilli, **10 Mins**
Urban Tadka, **12 Mins**

NATURE'S BOUNTY FOR NATURE LOVERS

NAMO Grand Central Park, **1 Min**

Rewale, **5 Mins**
Makhmali, **15 Mins**

Upvan, **15 Mins**

THE BEST OF HEALTHCARE

Jupiter Hospital, **8 Mins**

Bethany Hospital, **10 Mins**
Horizon Hospital, **15 Mins**

Hiranandani Hospital, **15 Mins**

SPIRITUALITY IS A VIRTUE

Iskon Temple, **1 Min**

Sai Baba Mandir, **10 Mins**

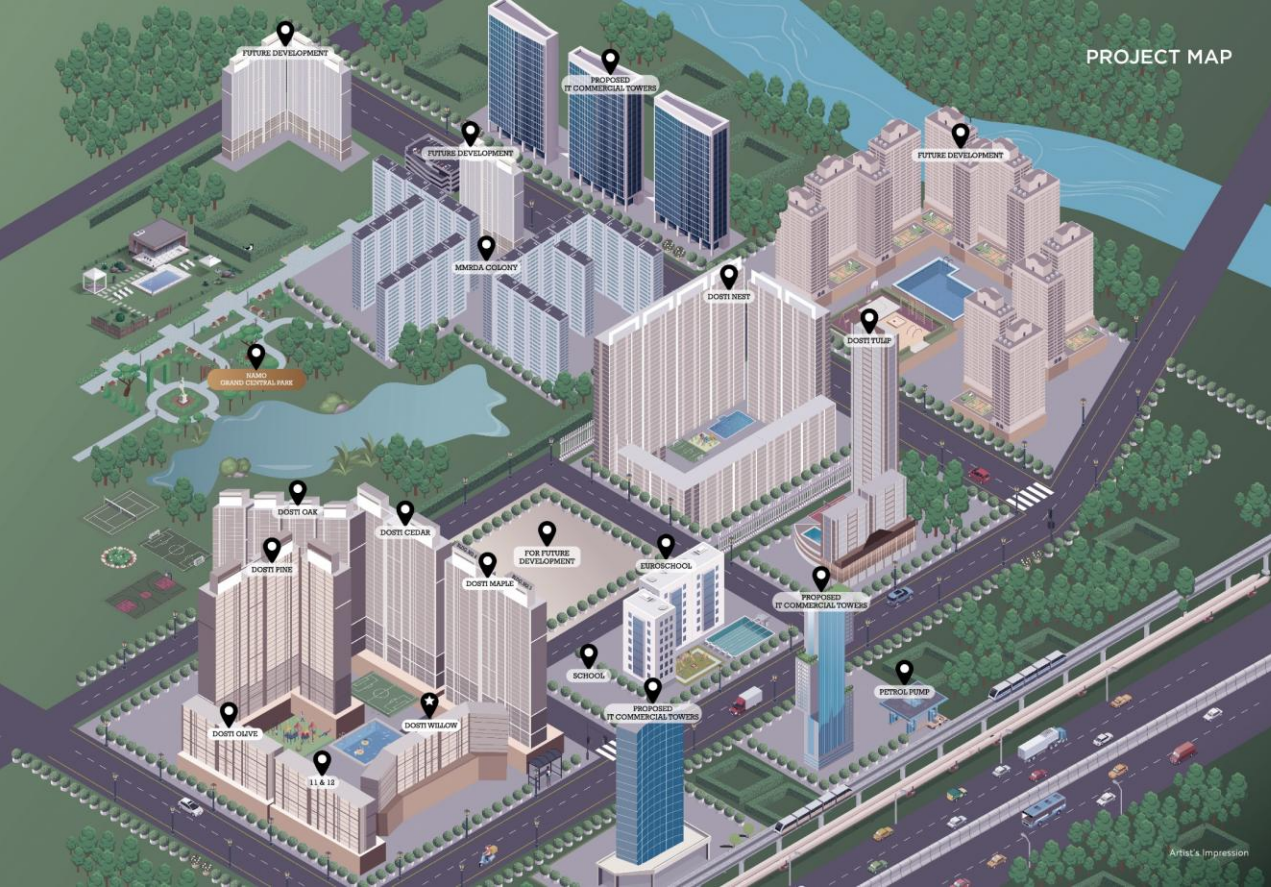

GET USED TO APPRECIATION
from your guests and future property valuations.

Dosti West County has proven itself to be a testament to an exceptional lifestyle and unparalleled growth. It has welcomed incredible appreciation of **30%** since its inception. Dosti West County has cemented itself as one of Thane's most coveted addresses.



A GLIMPSE INTO WHAT MAKES DOSTI WILLOW

the choice of Thane's new-age homebuyers.



SPACIOUS 2 & 3 BED ABODES

Large living rooms, expansive decks, and grand master bedrooms offering abundant natural light.



LARGE DECKS

Private outdoor spaces for serenity, relaxation, or vibrant gatherings with breathtaking views.



10'4" FLOOR-TO-FLOOR HEIGHT

Enhanced openness, larger windows, brighter spaces, and interiors designed for grandeur.



WOODEN FINISH BEDROOM TILES

Scratch-resistant, water-resistant, and elegant tiles that exude warmth and sophistication.



JACUAR TWO-TONED SANITARY FITTINGS

Corrosion-resistant, water-efficient fittings that add luxury and durability to your washrooms.



POWER BACKUP

Seamless power for lights, fans, and one large appliance ensures uninterrupted comfort.



KEYLESS LOCKS

Advanced security with biometric, keypad, or smartphone-enabled access for a hassle-free lifestyle.



DESIGNER LOBBY WITH WI-FI

Premium tiled lobby with integrated Wi-Fi sets a luxurious and connected first impression.



HOME AUTOMATION

Control lights and fans via remote or voice, ensuring convenience, energy efficiency, and security.



Disclosure: Building No. 11 & 12 will be developed in the balance portion of the layout in future in multiple phases

VAITARNA PIPELINE SERVICE ROAD

LIFE'S FINEST EXPERIENCES

under one roof.

1



Children's Activity Area

2



Cycling Track/
Strolling Path

3



Multipurpose Sports Court

4



Pool Pavilion
& Deck

5



Children's Adventure Pool
with Water Slide

6



Olympic-sized
Swimming Pool

7



Multipurpose
Lawn

8



The Merlion
Zone

9



Box
Cricket

10



Open-air
Amphitheatre

11



Lawn
Tennis

12



Resting
Plazas

13



Futsal
Court





Representative image

LIFE'S FINEST STROKES

in an Olympic-sized pool.

The Olympic-sized swimming pool celebrates indulgence and scale while elegant lounging spaces surround it. Sprawling and magnificent, it is an aquatic masterpiece crafted for those who revel in life's finest pleasures and never settle for the ordinary.



Actual image



LIFE'S FINEST PLAYDOM *for Thane's brightest.*

Gift your little ones the joys of a carefree childhood at Dosti Willow. With a play area and swimming pool designed for endless adventures, your children can enjoy more than just playing here. They can build their health and confidence, make lasting friendships and look forward to cherishing childhood memories that will echo for a lifetime.





Representative Image

LIFE'S FINEST SERVES AND SWINGS *for Thane's sportiest folks.*

Discover the thrill of the game with a lawn tennis court and box cricket arena crafted for champions in the making. Whether it's the precision of a perfect serve or the excitement of a winning shot, these spaces inspire fitness, focus, and teamwork in life.



THE FINEST COURTS
for the finest goals.

Step into a world of energy and excitement with futsal and multipurpose courts designed for every sports enthusiast. From thrilling mornings to dynamic evenings, these arenas are perfect for honing skills, boosting fitness, and bonding over sports with your loved ones.

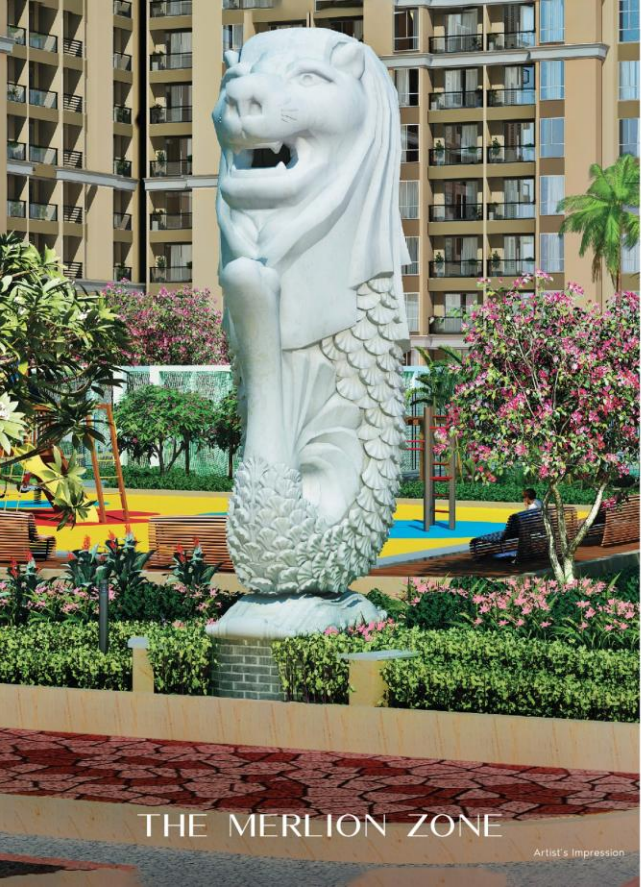

THE MERLION ZONE

Artist's Impression

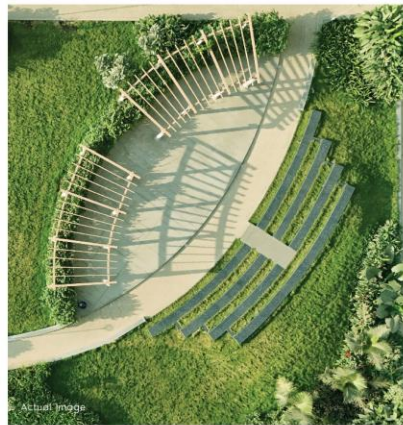

OPEN-AIR
AMPHITHEATRE



CYCLING TRACK & STROLLING PATH



Actual Image

AN EXTRAORDINARY CLUB EXPERIENCE

for Thane's extraordinary legacies.

Step into a realm where luxury meets leisure, where every experience is designed to inspire. Our state-of-the-art Clubhouse redefines indulgence with its world-class amenities, curated to elevate your lifestyle.



At Dosti Willow, we've partnered with the best to bring a world-class lifestyle to your doorstep. Our Clubhouse is managed by Ileseum Clubs, the pioneers of redefining the club experience.



Toddlers'
Play Area



Carrom and
Chess Room



Snooker
Room



Badminton
Courts



Squash
Courts



Table
Tennis



Co-working
Space



Foosball



Gymnasium



Cafeteria



E-Library



Library



Playstation

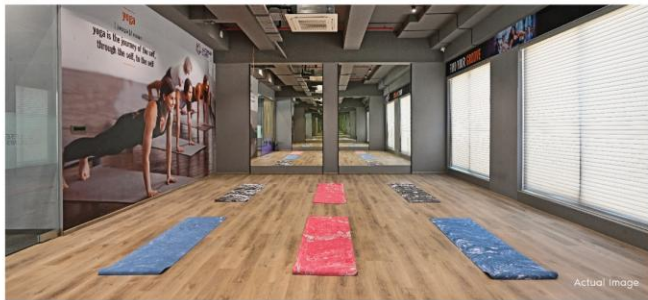

THE FINEST GIFTS *of health and wellness.*

Nurture your fitness journey at our world-class gym and yoga room. Spaces designed to challenge, inspire, and transform with state-of-the-art equipment and technology.





Actual Image



Representative Image

MAKE WAY FOR THE MOST *playful routines.*

Pleasure meets adrenaline at our indoor games arena. Adorn your breaks with the thrill of a fast-paced table tennis or badminton match, the intensity of a squash rally or a chess game, or the art of a perfect snooker, foosball or a carrom shot. Here, every game is designed to challenge, energise and entertain with impeccably designed spaces, professional equipment, and massive courts.



CARROM & CHESS ROOM

Actual Image



Actual Image

FOOSBALL



TABLE TENNIS & SNOOKER

Actual Image



THE QUIET HUM OF PRODUCTIVITY *meets the world of literature.*

The clubhouse at Dosti Willow is a haven of focus and productivity. The co-working space is designed to fuel innovation with cutting-edge infrastructure and seamless connectivity to keep your ideas flowing. Meanwhile, the library is a sanctuary for the curious, with a curated collection of books that enlighten, engage, and expand horizons.





SWEETEST OCCASIONS

meet memorable celebrations.

Dosti Westwood is an exclusive clubhouse that elevates your lifestyle at Dosti Willow. Come home to grand celebrations at our elegant pre-function area and banquet hall. With exquisitely designed spaces, state-of-the-art facilities, and impeccable service, no celebration is ordinary at Dosti Westwood.





Actual Image



Representative Image

TASTE LIFE'S FINEST FLAVOURS *without stepping out.*

Savour a culinary journey like no other at our signature restaurant. With a menu curated to delight every palate, exquisite ambiance, and impeccable service, every meal becomes an unforgettable experience.

THE FINEST HOSPITALITY

is at your disposal.

Extend the warmth of your home to your guests with our 9 luxurious guest rooms. Thoughtfully designed with modern amenities and elegant interiors, they offer the perfect blend of comfort and style.



THE FINEST MOVIE NIGHTS

when you want in the way you want.

Experience the magic of cinema in our AV room. Equipped with advanced acoustics, high-definition visuals, and plush seating, it's designed to captivate your senses and enhance your movie nights, private screenings, and interactive presentations.



Let your child's journey to an excellent future begin right next to your home with EuroSchool. It's one of India's leading education institutions, and now it is also your neighbour, known for its innovative curriculum, state-of-the-art infrastructure, world-class learning approach that nurtures academics and life skills in your little ones.

It is also the first school to get a safe school certification from a global audit firm, Bureau Veritas. Their student-centric learning practices include a National Education Policy (NEP) 2020-powered curriculum, a personalised digital learning ecosystem (ARGUS), a specially designed teacher training program to enhance the skills of their highly passionate teachers, and EuroBridge, a preparatory course for toddlers for the new academic year.





SHIAMAK DAVAR

INSTITUTE FOR
PERFORMING ARTS

SHIAMAK
Have feet. Will dance.®

Unleash rhythm and creativity in your little ones under the greatest guru of modern dance and the most respected global brand in the arena of dance training programs: Samplers and Workshops for Toddlers, Summer & Winter Funk, and Advanced Training Batches.

To know about fees, contact
Dosti Club County.



SURESH WADKAR

AJIVASAN
MUSIC ACADEMY



Ajivasan has been spreading the message of Hindustani Classical Music via Indian and Western Vocal and Instruments training to thousands for 86 years, where the students had the opportunity to perform with the master himself.

To know about fees, contact
Dosti Club County.



Representative Image

SAINA NEHWAL

EXPERT BADMINTON
COACHING ACADEMY



A premier coaching academy dedicated to nurturing the next generation of badminton champions under Head Coach Vijay Lancy, and a team of experienced mentors with a comprehensive training program that helps improve mental toughness, technique and strategy.

To know about fees, contact
Dosti Club County.



SAURAV GHOSAL

CUTTING-EDGE
SQUASH ACADEMY



A premier training destination by India's squash legend and Hotfut. Designed to inspire and develop athletes at all levels, SGS offers world-class coaching for technical precision, strategic gameplay, physical conditioning, and mental resilience for budding squash players.

To know about fees, contact
Dosti Club County.



Artist's Impression



THE FINEST ENTRANCE *and first impressions.*

Step into an exquisite lobby that speaks volumes before you even say a word. With its elegant finishes and impeccable design, this space exudes sophistication and sets the tone for the luxury that lies beyond.



COME HOME
to the finest art of living.

Step into a living room that redefines elegance and functionality. With thoughtfully curated interiors, expansive layouts, and an ambience of effortless sophistication, this is where moments turn into memories. Whether hosting guests or unwinding with family, the space invites you to unmatched comfort.

ESCAPE CHAOS

with the finest form of rest.

Discover a bedroom that's your private sanctuary. With plush finishes, serene decor, and layouts designed for ultimate relaxation, this is where you rise above the day's chaos and wake up to a world of tranquillity.



Shot at the Show Residence



Shot at the Show Residence

THE PERFECT RECIPE

is family cooking together.

Designed for the gourmet and the everyday chef alike, our kitchens boast intuitive layouts for your appliances and the days when the family wants to cook together.



THE FINEST VIEWS

are at your horizon.

Step out onto decks that blur the lines between indoors and natural bounty. Whether it's soaking in the morning sun or stargazing at night, these thoughtfully designed and majestic decks create the perfect setting to escape the confines of walls and embrace breathtaking views.



Representative Image

LIFE'S FINEST FEELING

is knowing your family is safe.

Live with peace of mind in an address fortified with advanced safety features. From 24/7 surveillance cameras and secure access control to child-safe designs, every precaution ensures you and your loved ones can rise above safety concerns and live confidently no matter the time.



NON-STOP SURVEILLANCE

With CCTV cameras and monitors in place across premises, your safety will always be in good hands.



SECURITY SYSTEMS

Superior security systems like Intercom and Access Control Cards at the podium and main entrance lobby.



FIRE ALARM

There are fire alarms in common areas and sprinkler systems in every apartment to ensure your safety.



GAS LEAK SENSORS

Every home will have the latest gas leak sensor to detect leaks early, and alerting you on time.

THOUGHTFUL SPECIFICATIONS

FLOORING

- Large-sized vitrified flooring in living/ dining room, bedroom, kitchen and passage

KITCHEN

- Premium solid surface kitchen platform with marble support
- Stainless steel sink of reputed make
- Dado tiles of reputed make

ELECTRICAL

- Air-conditioners (all bedrooms & living room) and switches with USB connectivity (all rooms)
- Electrical wiring & fitting of concealed type P.V.C. conduit. All switches of ISI Mark
- One ELCB per flat and MCB for each room
- TV, AC point, ceiling fan point and regulator point in living room and all bedrooms
- Telephone and Wi-Fi point provision in living room & master bedroom
- Power backup for one fan, one light and one heavy appliance within each flat

DOORS

- Flush doors with laminate finish in living room & bedrooms

WINDOWS

- Sliding windows with engineered frames and clear glass
- Mosquito nets for bedroom and living room
- Glass railing for living room balcony

PAINTING

- Gypsum finish on internal walls
- Premium eco-friendly quality paint for walls and ceilings

SANITARY

- Matt finish, anti-skid good quality tiles for all toilet flooring. All toilets with dado tiles
- Concealed plumbing with standard fittings, and sanitary fittings of standard make
- 15L hot water boiler
- Well-ventilated bathroom with an exhaust fan
- Shower partition in all bathrooms

SECURITY

- Intercom & video door phone system in each flat
- Keyless locks for the apartment's main door

BUILDING AMENITIES

- Designer tiles in the main lobby
- Wi-Fi connectivity in the main reception area
- Luxurious lift interiors finishing
- Electrical and power backup for common areas
- Security access control with CCTV provision at the main entrance lobby
- Fire fighting & fire alarm system for the building
- Society office
- Common toilets at ground floor level

LIFE'S FINEST HOME IS THE ONE

that also makes room for Mother Nature.



Representative Image

Embrace a lifestyle that's kind to nature and future-ready. With eco-friendly designs, energy-efficient systems, and abundant greenery, your home invites you to thrive in harmony with the environment.



SOLAR PANELS

To reduce energy costs and the burden from Mother Nature's shoulders.



LED LIGHTS

To help save on electricity bills and reduce carbon footprint.



ENERGY SAVING APPLIANCES

Minimize energy consumption to promote a more sustainable way of living.



MAXIMUM NATURAL VENTILATION

Enjoy a constant flow of fresh air while enhancing indoor air quality.



LOW VOC PAINTS

To avoid the risks of harmful emissions, and improve overall well-being.



RAINWATER HARVESTING SYSTEM

To use for gardening purposes and avoiding reliance on municipal sources.



WATER EFFICIENT FIXTURES

To help promote sustainability while conserving precious water resources.



RECYCLING OF WATER

Reusing treated water for non-potable uses for a more sustainable ecosystem.



NATIVE PLANT SPECIES FOR LANDSCAPING

Maintaining local biodiversity by incorporating low-maintenance plants.



WASTE MANAGEMENT

Centralised garbage disposal and waste management for a cleaner community.



A HEALTH CONSCIOUS ENVIRONMENT

Encouraging a healthy lifestyle through fitness facilities and green spaces.



SPECIALLY-ABLED FRIENDLY ACCESS

Ensure inclusivity and easy accessibility for all residents, regardless of ability.



DESIGN ARCHITECT

ARCHETYPE CONSULTANTS (I) PVT. LTD.

ACIPL is a multi-disciplinary architectural firm that specialises in housing, commercial, educational, institutional, city development, and hospitality sectors. Each team delivers unique solutions focusing on meticulous project detailing with a studio system approach. Founded on the principle that timeless architecture blends aesthetics, practicality, and functionality, it emphasises adaptability. Their notable projects include Sapphire Hospital (Thane), Seven Square Academy, and Impulse Tech Park. ACIPL has partnered with Dosti Realty for 15+ years, contributing expertise to projects like Dosti Vihar, Dosti Imperia, and Dosti Planet North.



STRUCTURAL CONSULTANT

JW CONSULTANTS LLP

Founded in 1975, JW Consultants LLP is a renowned firm combining superior design, quality standards, and compliance for over four decades. It has made its mark across various sectors globally, such as retail, residential, commercial, healthcare, hospitality, industrial, and institutional. Leveraging technical expertise, advanced software tools, and top talent, it annually delivers 70 million sq. ft. of space. Dosti Realty has partnered with JW for over 8 years, collaborating on projects like Dosti West County, Dosti Planet North, Dosti Eastern Bay, Dosti Greenscapes, and Dosti Lower Parel.



LANDSCAPE CONSULTANT

TAIB LANDSCAPE PVT. LTD,
SINGAPORE

Taib Landscape Pvt. Ltd. brings its expertise to Dosti West County through a team of landscape architects, horticulturists, and designers with over 20 years of experience in India and Southeast Asia. Under the lead of Ms. Saidah Taib, the studio has delivered remarkable residential & hospitality projects across cities like Mumbai, Bangalore & Goa. Notable projects include Aldeia-De-Goa Residential Villa, SEZ Hinjewadi Pune, and Avaneer Hinjewadi Pune. Taib Landscape has partnered with Dosti Realty since 2003, contributing to projects like Dosti Acres, Dosti Ambrosia, and Dosti Imperia.



MEP CONSULTANT

ENGINEERING CREATIONS
PUBLIC HEALTH CONSULTANCY
PVT. LTD.

ECPHC is best known for its multidisciplinary MEPF engineering design solutions that cater to various projects with processes designed to meet demands across multiple sectors. Engaged in service contracts of expert plumbing consultancy and fire fighting services for 16+ years, it aims to deliver an innovative technology without excessive cost overruns. They have worked on Nirlon Knowledge Center (Goregaon), Reliance Petroleum Ltd. (Jamnagar), and Bangalore Airport Expansion. Dosti Realty has established a strong partnership with ECPHC since 2012. They have delivered their best at Dosti Planet North and Dosti Parel.

LIAISON ARCHITECT

10 Folds Architects & Consultants

SOLICITORS

Vigil Juris

2 BHK - FLAT NO. 3 & 4	SQ. MTR.	SQ. FT.
RERA CARPET AREA	72.88	784
BALCONY AREA	4.49	48
TOTAL USABLE AREA	77.37	833

DOSTI WILLOW

A WING & B WING

2nd to 4th, 6th to 9th, 11th to 14th, 16th to 19th,
21st to 24th, 26th to 29th, 31st to 32nd floors

3 BHK - FLAT NO. 1 & 2	SQ. MTR.	SQ. FT.
RERA CARPET AREA	108.97	1173
BALCONY AREA	8.42	91
TOTAL USABLE AREA	117.39	1264

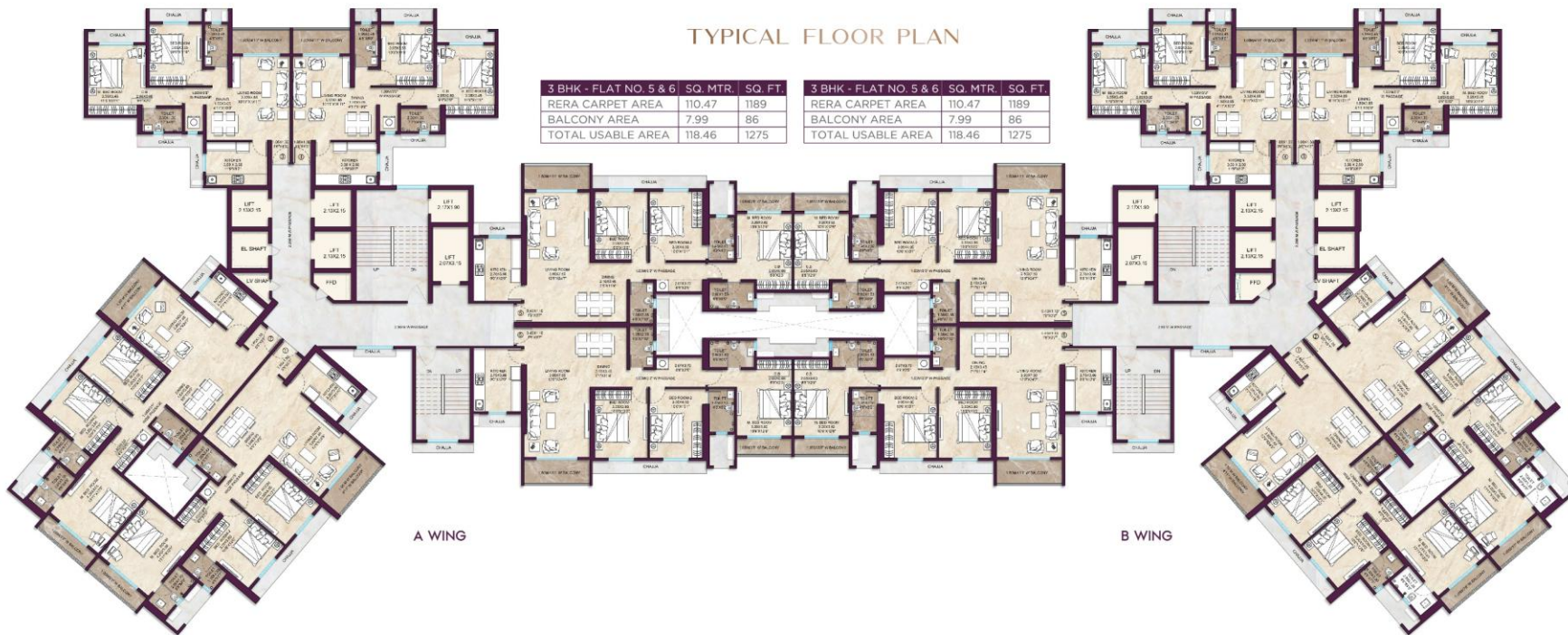

2 BHK - FLAT NO. 3 & 4	SQ. MTR.	SQ. FT.
RERA CARPET AREA	72.88	784
BALCONY AREA	4.49	48
TOTAL USABLE AREA	77.37	833

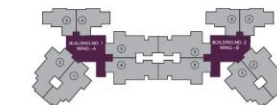

3 BHK - FLAT NO. 1 & 2	SQ. MTR.	SQ. FT.
RERA CARPET AREA	108.97	1173
BALCONY AREA	8.42	91
TOTAL USABLE AREA	117.39	1264



DOSTI WILLOW

A WING & B WING

5th, 10th, 15th, 20th, 25th & 30th floors

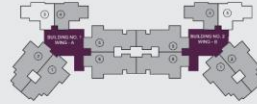

2 BHK - FLAT NO. 4	SQ. MTR.	SQ. FT.
RERA CARPET AREA	72.88	784
BALCONY AREA	4.49	48
TOTAL USABLE AREA	77.37	833

REFUGE FLOOR PLAN

2 BHK - FLAT NO. 4	SQ. MTR.	SQ. FT.
RERA CARPET AREA	72.88	784
BALCONY AREA	4.49	48
TOTAL USABLE AREA	77.37	833



3 BHK - FLAT NO. 1 & 2	SQ. MTR.	SQ. FT.
RERA CARPET AREA	108.97	1173
BALCONY AREA	8.42	91
TOTAL USABLE AREA	117.39	1264

3 BHK - FLAT NO. 1 & 2	SQ. MTR.	SQ. FT.
RERA CARPET AREA	108.97	1173
BALCONY AREA	8.42	91
TOTAL USABLE AREA	117.39	1264



Please Note: The interiors, furniture, fittings, fixtures, etc. shown in the image/drawing are only artist's conception and not part of actual amenities provided. The actual amenities as mentioned in the Agreement for Sale shall be final and provided in the premises.

DOSTI WILLOW

A WING & B WING

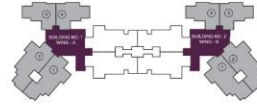

2 BHK - FLAT NO. 3 & 4	SQ. MTR.	SQ. FT.
RERA CARPET AREA	72.88	784
BALCONY AREA	4.49	48
TOTAL USABLE AREA	77.37	833

1ST FLOOR/ SERVICE FLOOR PLAN

2 BHK - FLAT NO. 3 & 4	SQ. MTR.	SQ. FT.
RERA CARPET AREA	72.88	784
BALCONY AREA	4.49	48
TOTAL USABLE AREA	77.37	833

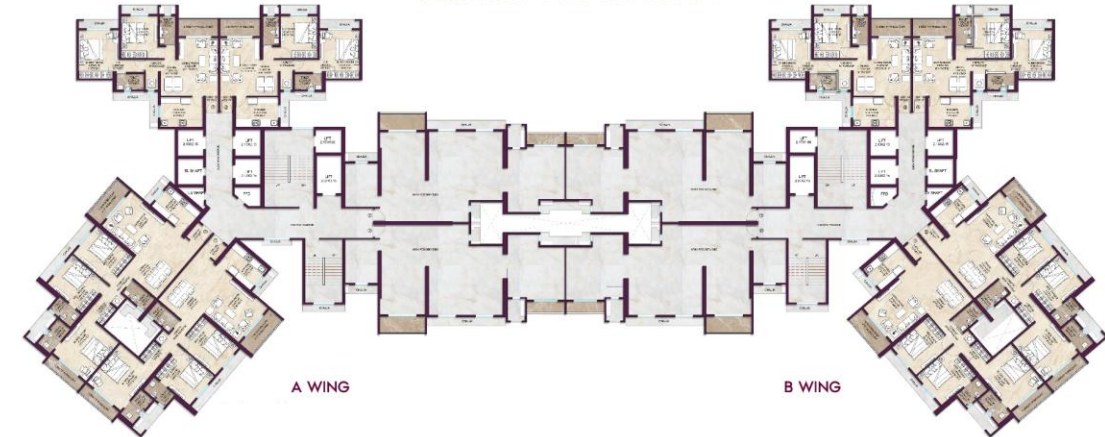

3 BHK - FLAT NO. 1 & 2	SQ. MTR.	SQ. FT.
RERA CARPET AREA	108.97	1173
BALCONY AREA	8.42	91
TOTAL USABLE AREA	117.39	1264

3 BHK - FLAT NO. 1 & 2	SQ. MTR.	SQ. FT.
RERA CARPET AREA	108.97	1173
BALCONY AREA	8.42	91
TOTAL USABLE AREA	117.39	1264



All dimensions of carpet area are from unfinished wall surface. Minor variations/tolerance of +/- 3% in carpet area may occur on account of design and/or construction exigencies. *Conversion: 1 sq. mt. = 10.764 sq. ft. *Conversion in square feet for convenience purpose & easy understanding.

A WING FLOOR PLANS

DOSTI WILLOW A WING 3 BED FLAT NO. 1 & 2



3 BHK - FLAT NO. 1 & 2	SQ. MTR.	SQ. FT.
RERA CARPET AREA	108.97	1173
BALCONY AREA	8.42	91
TOTAL USABLE AREA	117.39	1264

DOSTI WILLOW A WING 2 BED FLAT NO. 3 & 4



2 BHK - FLAT NO. 3 & 4	SQ. MTR.	SQ. FT.
RERA CARPET AREA	72.88	784
BALCONY AREA	4.49	48
TOTAL USABLE AREA	77.37	833

DOSTI WILLOW A WING 3 BED FLAT NO. 5 & 6



3 BHK - FLAT NO. 5 & 6	SQ. MTR.	SQ. FT.
RERA CARPET AREA	110.47	1189
BALCONY AREA	7.99	86
TOTAL USABLE AREA	118.46	1275

Please Note: The interiors, furniture, fittings, fixtures, etc. shown in the image/drawing are only artist's conception and not part of actual amenities provided. The actual amenities as mentioned in the Agreement for Sale shall be final and provided in the flats. All dimensions of carpet area are from unfinished wall surface. Minor variations/tolerance of +/- 3% in carpet area may occur on account of design and/or construction exigencies. *Conversion: 1 sq. mt = 10.764 sq. ft. *Conversion in square feet for convenience purpose & easy understanding.

B WING FLOOR PLANS

DOSTI WILLOW B WING 3 BED FLAT NO. 1 & 2

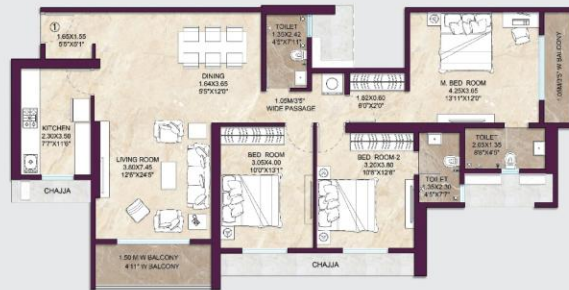

3 BHK - FLAT NO. 1 & 2	SQ. MTR.	SQ. FT.
RERA CARPET AREA	108.97	1173
BALCONY AREA	8.42	91
TOTAL USABLE AREA	117.39	1264

DOSTI WILLOW B WING 2 BED FLAT NO. 3 & 4

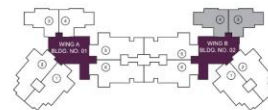

2 BHK - FLAT NO. 3 & 4	SQ. MTR.	SQ. FT.
RERA CARPET AREA	72.88	784
BALCONY AREA	4.49	48
TOTAL USABLE AREA	77.37	833

DOSTI WILLOW B WING 3 BED FLAT NO. 5 & 6

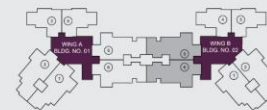

3 BHK - FLAT NO. 5 & 6	SQ. MTR.	SQ. FT.
RERA CARPET AREA	110.47	1189
BALCONY AREA	7.99	86
TOTAL USABLE AREA	118.46	1275

Please Note: The interiors, furniture, fittings, fixtures, etc. shown in the image/drawing are only artist's conception and not part of actual amenities provided. The actual amenities as mentioned in the Agreement for Sale shall be final and provided in the flats. All dimensions of carpet area are from unfinished wall surface. Minor variations/tolerance of +/- 3% in carpet area may occur on account of design and/or construction exigencies. *Conversion: 1 sq. mt = 10.764 sq. ft. **Conversion in square feet for convenience purpose & easy understanding.

40+

YEARS OF EXPERTISE

135

PROPERTIES DELIVERED

21,300+

HAPPY FAMILIES

13 MILLION

SQ. FT. DELIVERED

21 MILLION

SQ. FT. UNDER CONSTRUCTION

100%

PROJECT DELIVERED ON TIME

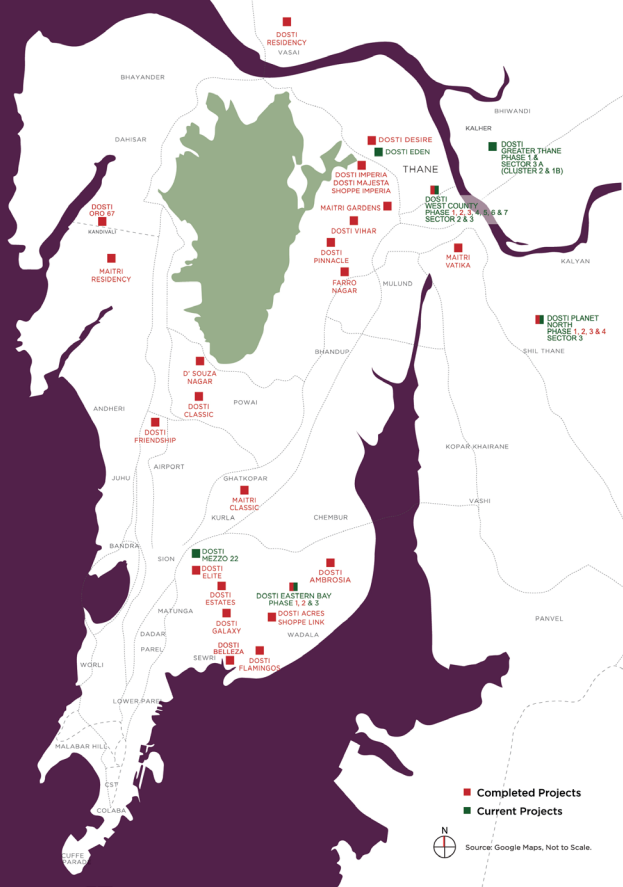

A LEGACY MADE BY AND FOR

friends for life.

For over four decades, Dosti Realty has been a symbol of trust and excellence in the real estate sector. With a legacy rooted in understanding the evolving needs of our customers, we have transformed not just pin codes but lives—building enduring communities that nurture relationships and growth. We have successfully delivered over 13 million sq. ft. across more than 135 properties. We take pride in shaping over 21,300 residences into homes where families thrive together.

At Dosti Realty, understanding is the cornerstone of our ethos, 'Friends for Life.' This philosophy has been refined through years of listening, learning, and innovating to meet the aspirations of homebuyers. From timeless architecture and thoughtfully designed spaces to consistent construction updates and exceptional post-possession support, we make every step of the home-buying journey seamless and rewarding. More than just buildings, we create spaces that foster connection, harmony, and a profound sense of belonging.

Our commitment to excellence and innovation drives us to shape the future with over 21 million sq. ft. of developments planned across the Mumbai Metropolitan Region and Pune. These include thoughtfully designed residences, educational institutions, commercial hubs, retail spaces and IT parks—each crafted to inspire comfort and connection. Grounded in values like trust, transparency, quality and timely delivery, Dosti Realty remains dedicated to building brighter futures and nurturing communities for generations to come.

IT'S MORE THAN
JUST BUILDING HOMES.

IT IS ABOUT TRANSFORMING
LIVES AND PIN CODES.



DOSTI EASTERN BAY
WADALA



MahaRERA No. P51900032067



DOSTI MEZZO 22
SION



MahaRERA No. P51900026976



DOSTI EDEN
AT DOSTI DESIRE, PHASE 2
THANE (W)



MahaRERA No. P51700049421



DOSTI MAPLE
AT DOSTI WEST COUNTY
THANE (W)



MahaRERA No. P51700054424



DOSTI PINE
AT DOSTI WEST COUNTY
THANE (W)



MahaRERA No. P51700025834



DOSTI OLIVE
AT DOSTI WEST COUNTY
THANE (W)



MahaRERA No. P51700054037



DOSTI TULIP
AT DOSTI WEST COUNTY
THANE (W)



MahaRERA No. P51700032666



DOSTI NEST
AT DOSTI WEST COUNTY
THANE (W)



MahaRERA No. P51700050253



DOSTI GREATER THANE
KALHER



MahaRERA No. P51700048333



DOSTI GREENSCAPES
PUNE



MahaRERA No. P52100077059

Iconic Residential Project
DOSTI WEST COUNTY
Mid-Day International Real Estate
& Infrastructure Icons Awards, 2024
☆☆☆

Excellence in Townships
Projects
DOSTI WEST COUNTY
Times Real Estate Conclave
and Awards, 2023-24
☆☆☆

Leading Real Estate
Developer of The Year
DOSTI REALTY LTD.
Credai MCHI Golden Pillar
Awards, 2023
☆☆☆

Best Marketing Campaign
of The Year
DOSTI 1 MUMBAI
Credai MCHI Golden Pillar
Awards, 2023
☆☆☆

Iconic Residential Project Pune
DOSTI GREENSCAPES
Mid-Day International Real Estate
& Infrastructure Icons Awards, 2023
☆☆☆

Iconic Real Estate Brand
of the Year
DOSTI REALTY LTD.
Times Real Estate Conclave
& Awards, 2023
☆☆☆

Iconic Project of The Year,
Beyond Thane
DOSTI GREATER THANE, KALHER
Mid-Day Gems of India
Awards, 2023
☆☆☆

Iconic Premium Residential Project
DOSTI MEZZO 22, SION
Mid-Day International Real Estate
& Infrastructure Icons Awards, 2022
☆☆☆

Project of the Year
DOSTI NEST, THANE (W)
Mid-Day International Real Estate
& Infrastructure Icons Awards, 2022
☆☆☆

Iconic Residential Project
of the Year, South Mumbai
DOSTI EASTERN BAY, WADALA
Times Real Estate Conclave
& Awards, 2021
☆☆☆

Upcoming Residential Project,
Western Suburbs
DOSTI ORO 67, KANDIVALI (W)
Mid-Day Real Estate International
Icons Award, 2021
☆☆☆

Iconic Residential Project
South Mumbai
DOSTI EASTERN BAY, WADALA
Hindustan Times Real Estate
Titans, 2020
☆☆☆

Iconic Luxury Homes,
South Mumbai
DOSTI EASTERN BAY, WADALA
Mid-Day Real Estate Icons
Awards, 2020
☆☆☆

Developer of the Year
Residential
DOSTI REALTY
Real Estate Business Excellence
Awards, 2020 in association with
CNN-News 18
☆☆☆

Iconic Planned Project,
Central Mumbai
DOSTI WEST COUNTY, THANE (W)
Mid-day Real Estate Icons
Awards, 2019
☆☆☆

Iconic Planned Project
Central Mumbai
DOSTI WEST COUNTY, THANE (W)
Mid-Day Real Estate & Infrastructure
Icons Awards, 2019
☆☆☆

Best Project of the Year,
Thane
DOSTI WEST COUNTY, THANE (W)
Accommodation Times, 2018
☆☆☆

Ultimate Residential project,
Thane
DOSTI WEST COUNTY, THANE (W)
Hindustan Times, 2018
☆☆☆

Residential Project of the Year,
Thane
DOSTI DESIRE, THANE (W)
Accommodation Times, 2018
☆☆☆

Excellence in Quality
Residential Projects
DOSTI REALTY LTD.
Lokmat Corporate Excellence
Awards, 2018
☆☆☆

Best Developer Residential
DOSTI REALTY LTD.
ET Now, 2018
☆☆☆

Best Green Building
DOSTI AMBROSIA, WADALA
ET Now, 2018
☆☆☆

Real Estate Industry
Achievement Award
DOSTI REALTY LTD.
Grahe Hurun, 2017
☆☆☆

Iconic Residential Project,
DOSTI DESIRE, THANE (W)
Mid-Day Real Estate Icons, 2017
☆☆☆

Iconic Developer Thane
DOSTI REALTY LTD.
Mid-Day Real Estate Icons
(Thane & Navi Mumbai), 2017
☆☆☆

Iconic Residential Project
Beyond Thane
DOSTI PLANET NORTH, SHIL THANE
Mid-Day Real Estate Icons
(Thane & Navi Mumbai), 2017
☆☆☆

Times Realty Icons
DOSTI PLANET NORTH, SHIL THANE
In the category of Value Homes
(Thane & Beyond), 2017
☆☆☆

Times Realty Icons
DOSTI MAJESTA, GHODBUNDER ROAD,
THANE (W)
In the category of Ultra Luxury
Homes (Thane & Beyond), 2017
☆☆☆

Project of the Year
DOSTI AMBROSIA, WADALA
31st National Real Estate Awards
by Accommodation Times, 2017
☆☆☆

Iconic Residential Project
South Mumbai
DOSTI AMBROSIA, WADALA
Mid-Day Real Estate Icons
Awards, 2016
☆☆☆

Certified Gold Rating under
IGBC for Green Building
DOSTI AMBROSIA, WADALA
LEED, 2016
☆☆☆

#2 at the Exhibition
for Gardening
DOSTI ACRES, WADALA
Veermata Jeejabai Bhosle Garden,
Byculla by the Tree Authority and Brihan
Mumbai Mahanagarpalika, 2015
☆☆☆

Best Residential Project
of the Year
DOSTI AMBROSIA, WADALA
Construction Times, 2015
☆☆☆

Premium Apartment Project
of the Year (West)
DOSTI VIHAR, THANE (W)
NDTV, 2015
☆☆☆

Mumbai's Top Developer
DOSTI REALTY LTD
For on-time delivery and
possession by NDTV, 2014
☆☆☆

Project of the Year
DOSTI VIHAR, THANE (W)
Accommodation Times, 2014
☆☆☆

Pre-certified Green Building
aiming for Gold rating
DOSTI IMPERIA, THANE (W)
LEED, 2013
☆☆☆

An Artist in Concrete Awards
DOSTI VIHAR, THANE (W)
Space Planning, Big Residential
projects by REIFY Artisans & Projects
Pvt. Ltd., 2013
☆☆☆

Certified Company by URS
DOSTI REALTY LTD
OHSAS 18001: 2007 (2018)
& ISO 9001:2008 (2012)
☆☆☆

Best Maintained Podium Garden
DOSTI ACRES, WADALA
Municipal Corporation of Mumbai
for 2008, 2009, 2010
☆☆☆



Site Address: Dosti West County – Dosti Willow, Dosti West County Road, near upcoming Balkum Naka Metro Station, Thane West - 400608 T: 86577 03367
Corp. Address: Dosti Enterprises, Lawrence & Mayo House, 1st Floor, 276, Dr. D. N. Road, Fort, Mumbai 400 001 • www.dostirealty.com

Disclosures: (1) The artist's impressions and stock images used for representation purpose only. (2) Furniture, fittings and fixtures as shown/displayed in the show premises are for the purpose of showcasing only and do not form part of actual standard amenities to be provided in the premises. The premises offered for sale are unfurnished and all the amenities proposed to be provided in the premises shall be incorporated in the Agreement for Sale. (3) The right to admission, use and enjoyment of all or any of the facilities/amenities in the Dosti Club County is reserved by the Promoters exclusively for residential premises and the same shall be subject to payment of such admission fees, annual charges and compliance of terms and conditions as may be specified from time to time by the Promoters. (4) The sale of all the premises in above mentioned projects shall be governed by terms and conditions incorporated in the Agreement for Sale.

DOSTI REALTY LTD. ISO 9001:2015 & ISO 45001:2018 CERTIFIED