



Artist's Impression



DOSTI TULIP

RETAIL SPACES - FLOOR PLAN BOOKLET

Dosti West County - Dosti Tulip project is registered under MahaRERA No. P51700032666 and is available on website - <https://maharera.mahaonline.gov.in> under registered projects

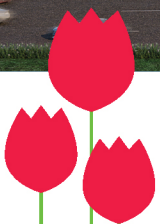

THE IDEAL DESTINATION FOR EVERYTHING



Thane, the crowning glory of Mumbai, is the city of well-preserved lakes which withholds nature's pristine bounties. Rapid development and exemplary infrastructure has made Thane the most sought-after future-ready city on the global map. Being easily accessible to prominent destinations of work, leisure and entertainment, makes Thane an apt destination.

- Eastern Express Highway - 3 Mins
- Mulund - 15 Mins
- Airoli - 25 Mins
- Powai - 30 Mins
- Ghansoli - 30 Mins
- Mahape - 32 Mins
- BKC - 35 Mins
- Vashi - 35 Mins
- Andheri - 40 Mins
- SEEPZ - 40 Mins
- Kalyan - 40 Mins
- Borivali - 45 Mins
- Chhatrapati Shivaji International Airport - 45 Mins
- Goregaon - 50 Mins
- Nerul - 55 Mins
- Fort - 60 Mins
- Parel - 60 Mins
- Panvel - 65 Mins

Source: Google Maps. As per Normal Traffic Conditions.

- Airport
- Eastern Express Highway
- Western Express Highway
- Ghodbunder Road
- Old Mumbai - Pune Road (NH 4)
- Thane - Belapur Road
- Chembur - Jacob Circle Monorail Line
- Santacruz - Chembur Link Road
- Eastern Freeway
- Bandra - Worli Sea Link
- Business Hub
- Ghatkopar - Versova Metro Line 1
- Western Railway
- Central Railway
- Harbour Railway
- Ferry Wharf Jetty

UNDER CONSTRUCTION INFRASTRUCTURE

- DN Nagar - Dahisar Metro Line 2A (Partly operational)
- DN Nagar - Bandra - Mandale Metro Line 2B
- Colaba - Bandra - Seepz Metro Line 3
- Wadala - Ghatkopar - Thane Metro Line 4
- Thane - Bhiwandi - Kalyan Metro Line 5
- Swami Samarth Nagar - Jogeshwari - Vikhroli Metro Line 6
- Andheri (E) - Dahisar (E) Metro Line 7 (Partly operational)
- Dahisar (E) - Mira Bhayandar Metro Line 7A
- CSIA - Navi Mumbai International Airport Metro Line 8
- Dahisar (E) - Mira Bhayandar Metro Line 9
- Wadala - GPO (CST) Metro Line 11
- Mumbai Coastal Road
- Mumbai Trans Harbour Link (Sewri - Nhava Sheva)
- Mumbra - Airoli Tunnel
- Navi Mumbai International Airport
- Thane Water Ways Transport Along Ulhas River (Thane to Vasai, Kalyan & Bhiwandi)

PROPOSED INFRASTRUCTURE

- Thane - Borivali Tunnel
- Virar - Alibaug Multi-modal transport Corridor
- Thane - Dombivli Flyover
- Metro Line 10 Gaimukh (Ghodbunder) - Shivaji Chowk (Mira Road)
- Metro Line 12 Kalyan - Taloja
- Kolshet Jetty
- Bandra - Versova Sea Link
- Coastal Road from Kandivali to Ghodbunder Road
- Worli to Sewri Connector
- Eastern Freeway (Chembur to Thane)
- Coastal Road (Balkum to Gaimukh)

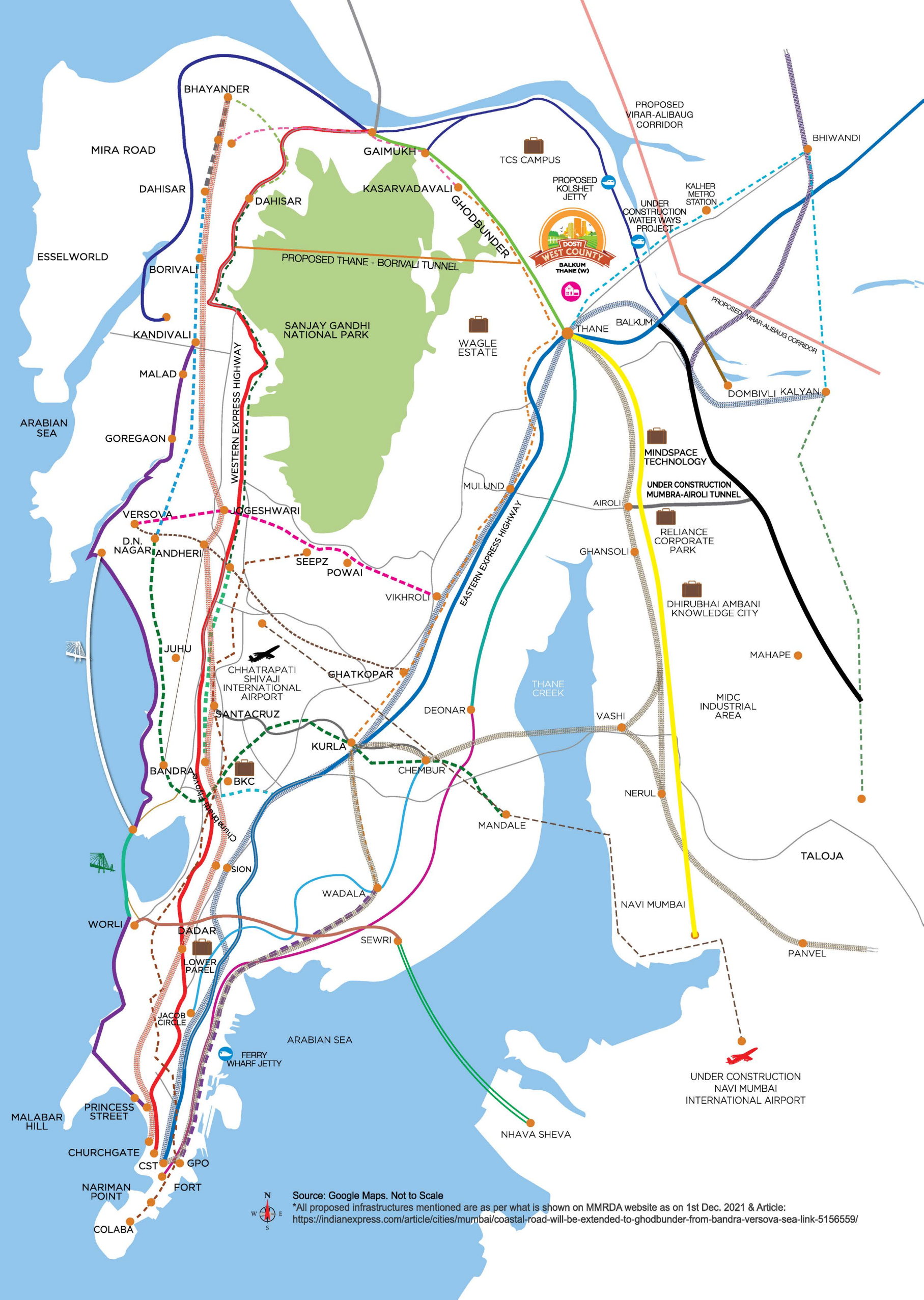

Source: Google Maps. Not to Scale
 *All proposed infrastructures mentioned are as per what is shown on MMRDA website as on 1st Dec. 2021 & Article: <https://indianexpress.com/article/cities/mumbai/coastal-road-will-be-extended-to-ghodbunder-from-bandra-versova-sea-link-5156559/>



DOSTI WEST COUNTY TENTATIVE MASTER LAYOUT

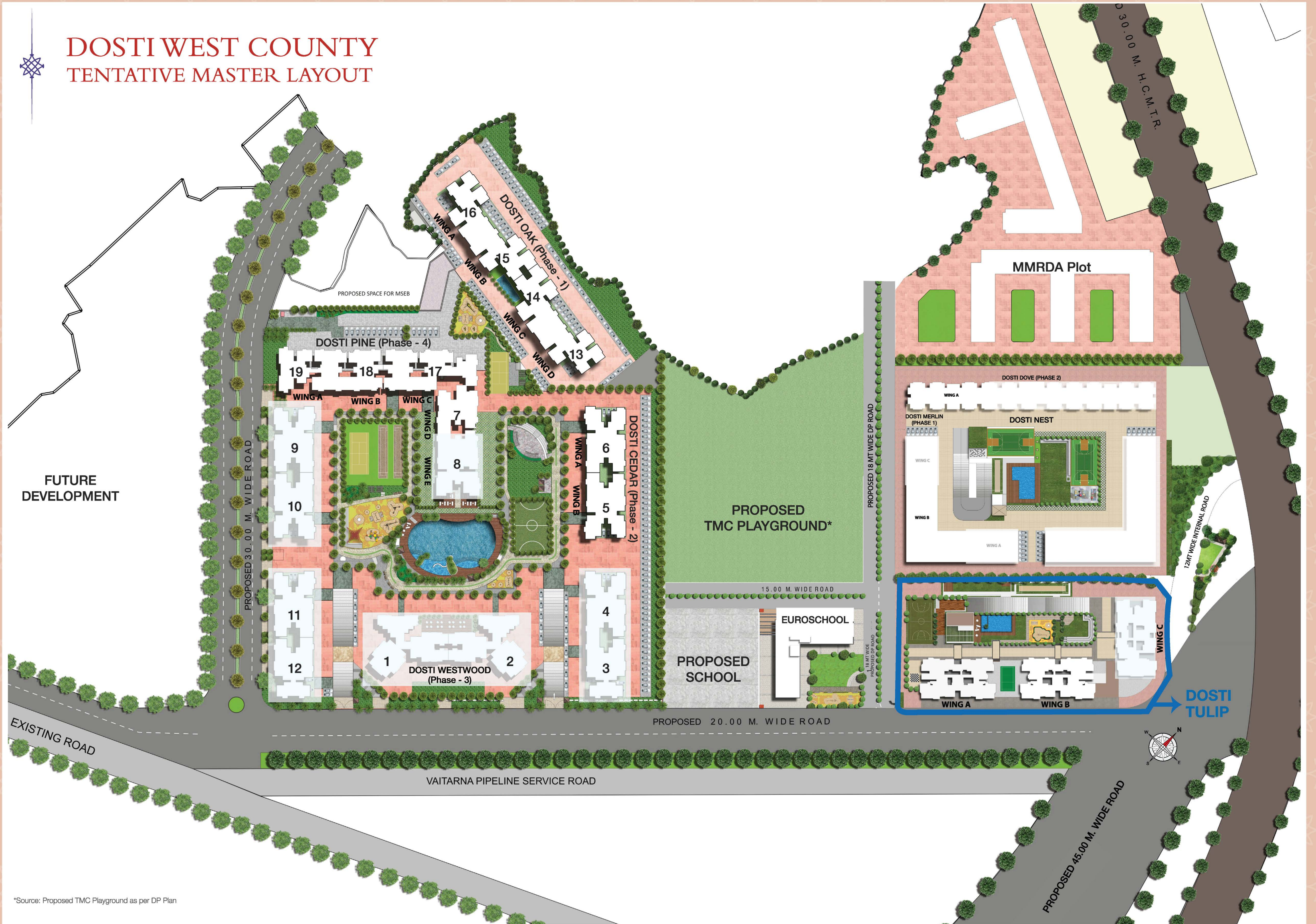

*Source: Proposed TMC Playground as per DP Plan

DOSTI WEST COUNTY - DOSTI TULIP

DOSTI TULIP



12.00 M. WIDE INT. ROAD

18 MT WIDE
PROPOSED DP ROAD

PROPOSED 20.00 M. WIDE ROAD

PROPOSED 45.00 M. WIDE ROAD



WING A

WING B

WING C

DOSTI TULIP RETAIL SPACES

CLUBHOUSE





Artist's Impression



RETAIL FLOOR PLAN

TOTAL HEIGHT WITH SLAB	14'3"
SHOP CLEAR INTERNAL HEIGHT	13'9"

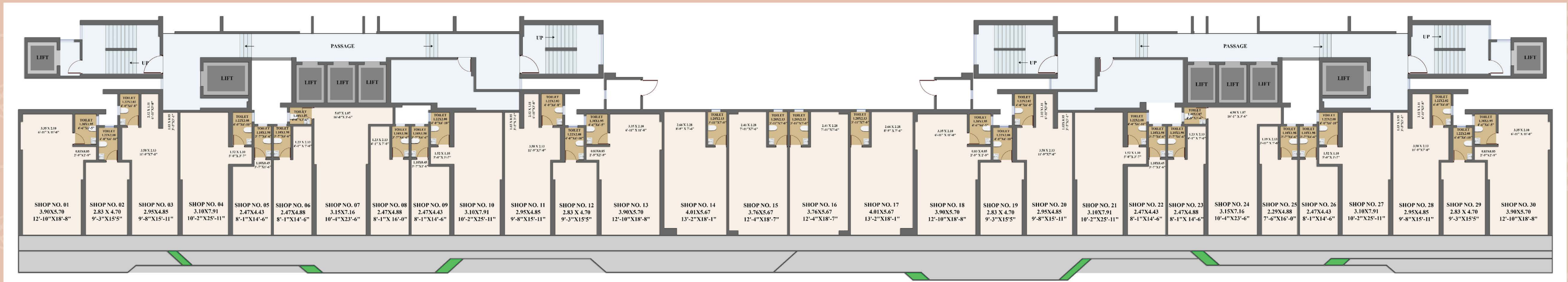

SHOP NO.	SHOPS RERA CARPET AREA		SHOP FRONTAGE FEET
	SQ.MT	SQ.FT*	
1	31.62	340	11'4"
2	15.00	161	8'10"
3	27.22	293	9'8"
4	27.86	300	9'8"
5	13.32	143	8'1"
6	16.53	178	8'1"
7	30.20	325	10'6"
8	16.53	178	8'1"
9	13.32	143	8'1"
10	27.86	300	9'8"
11	27.22	293	9'8"
12	15.00	161	8'10"
13	31.62	340	12'4"
14	30.54	329	10'3"
15	28.77	310	10'5"

SHOP NO.	SHOPS RERA CARPET AREA		SHOP FRONTAGE FEET
	SQ.MT	SQ.FT*	
16	28.77	310	10'5"
17	30.54	329	10'6"
18	31.62	340	12'4"
19	15.00	161	8'10"
20	27.22	293	9'8"
21	27.86	300	9'8"
22	13.32	143	8'1"
23	15.66	169	7'6"
24	28.93	311	10'4"
25	15.66	169	7'6"
26	13.39	144	8'1"
27	27.86	300	9'8"
28	27.22	293	9'8"
29	15.00	161	8'10"
30	31.62	340	12'4"

Please Note: All dimensions of carpet area are from un_nfinished wall surface. Minor variations/tolerance of +/- 3% in carpet area may occur on account of design and/or construction exigencies. *Conversion: 1 sq. mt. = 10.764 sq. ft. *Conversion in square feet for convenience purpose & easy understanding





DISCOVER YOUR FRIENDS FOR LIFE

Dosti Realty has been in the real estate business for over 4 decades and delivered more than 127 properties to date, providing homes to over 10,000+ families. Encompassing a portfolio of having delivered over 11.44 million. sq. ft. and currently constructing around 6 million. sq. ft. across Mumbai and Thane, the company has an experience in various development types, be it Residential, Retail, IT Parks, etc. Over the years, it has been known for Aesthetics, Innovation, Quality, Timely Delivery, Trust, and Transparency, Values that have built lasting relationships.

Dosti Ambrosia - New Wadala

Actual Image

Dosti Mezzo 22 Sion

Artist's Impression

MahaRERA No. P51900026976

Dosti Eastern Bay New Wadala

Artist's Impression

Phase 1 - MahaRERA No. P51900025142
Phase 2 - MahaRERA No. P51900030769
Phase 3 - MahaRERA No. P51900032067

Dosti Belleza - Parel

Actual Image

MahaRERA No. P51900015989

Dosti Flamingos - Parel-Sewri

Actual Image

Dosti West County - Dosti Nest Balkum, Thane (W)

Artist's Impression

Phase 1 - MahaRERA No. P51700033640
Phase 2 - MahaRERA No. P51700033663

Dosti Oro 67 Kandivali

Artist's Impression

MahaRERA No. P51800029143

Dosti Imperia - Dosti Majesta Ghodbunder Road, Thane (W)

Actual Image

MahaRERA No. P51700010988

Dosti Desire - Thane (W)

Actual Image

Dosti Desire - Dosti Pearl MahaRERA No. P51700005623
Dosti Desire - Dosti Joy MahaRERA No. P51700008886

Dosti Planet North - Sector 3 Shil - Thane

Artist's Impression

MahaRERA No. P51700034985

Dosti Greater Thane Kalher

Artist's Impression

Phase 1 - MahaRERA No. P51700024923



■ Completed Projects

■ Current Projects



Source: Google Maps, Not to Scale.



Site Address: Dosti West County, Dosti Tulip, Balkum, Off Old Mumbai-Agra Road, Thane-Bhiwandi-Wadpa Road, Thane (W) 400 608. T: 86577 03367

Corp. Address: Dosti Enterprises, Lawrence & Mayo House, 1st Floor, 276, Dr. D. N. Road, Fort, Mumbai 400 001 • www.dostirealty.com

Dosti West County - Dosti Oak project is registered under MahaRERA No. P51700006565, Dosti West County - Phase 2 - Dosti Cedar project is registered under MahaRERA No. P51700015258, Dosti West County - Phase 3 - Dosti Westwood project is registered under MahaRERA No. P51700015501, Dosti West County - Phase 4 - Dosti Pine project is registered under MahaRERA No. P51700025834, Dosti West County - Dosti Tulip project is registered under MahaRERA No. P51700032666, Dosti West County - Dosti Nest - Phase 1 project is registered under MahaRERA No. P51700033640 & Dosti West County - Dosti Nest - Phase 2 project is registered under MahaRERA No. P51700033663 and are available on website - <https://maharera.mahaonline.gov.in> under registered projects.

Disclosures: (1) The artist's impressions and stock images used for representation purpose only. (2) The sale of all the commercial premises in Dosti West County - Dosti Tulip project shall be governed by terms and conditions incorporated in the Agreement for Sale. (3) This project is funded by Kotak Mahindra Investments Limited, Kotak Mahindra Prime & Kotak Mahindra Bank Ltd.

